

A

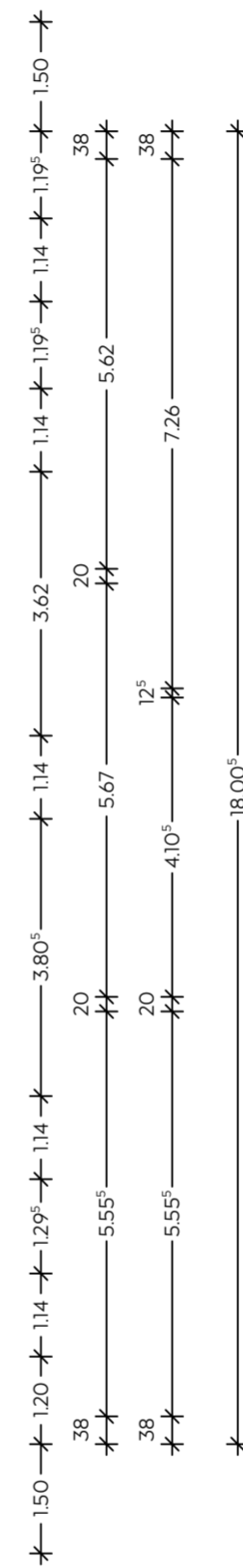
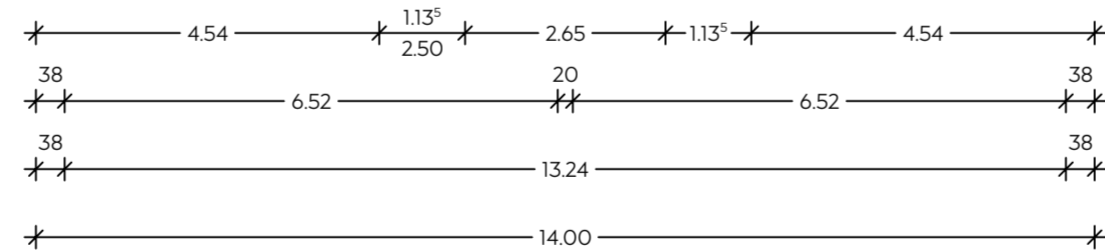
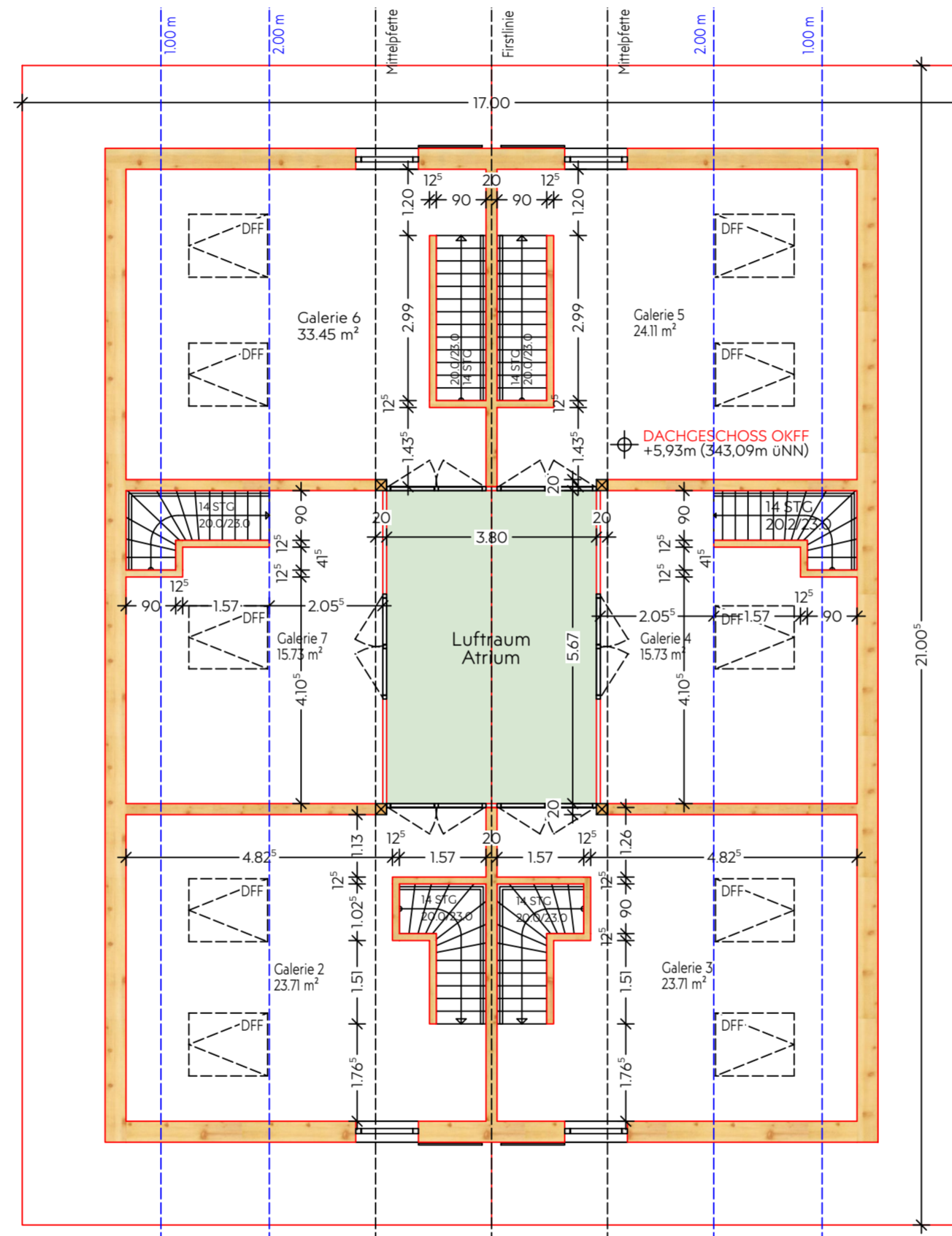
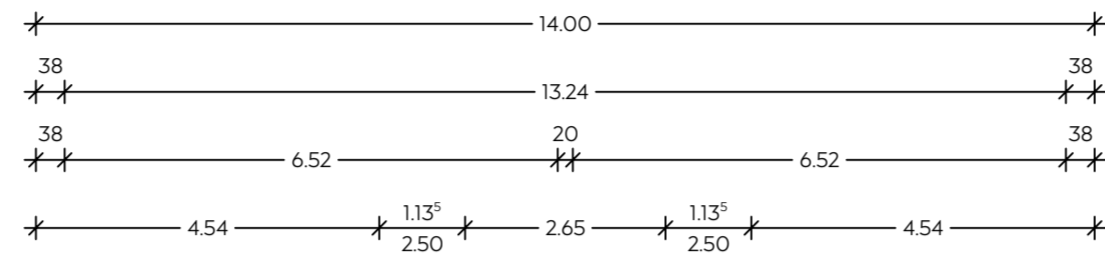
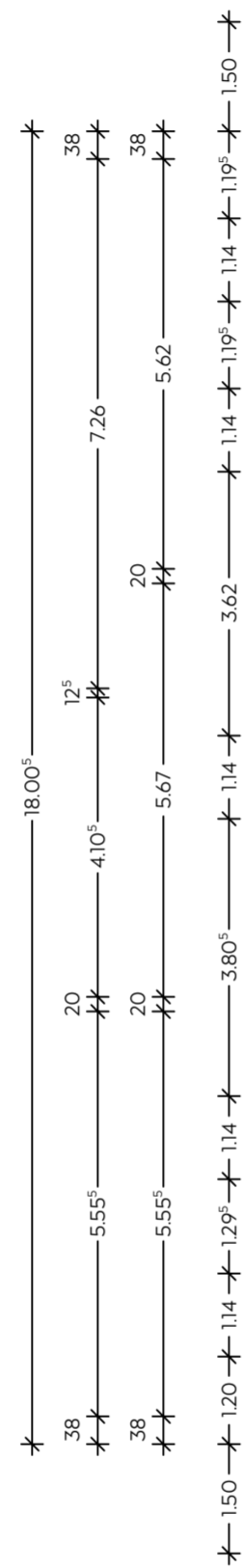

A

STATUS	BAUANTRAG VORABZUG		<input type="checkbox"/> BESTAND
			<input checked="" type="checkbox"/> NEUBAU
			<input type="checkbox"/> ABBRUCH
PROJEKT	BVH Waldrain Carl-Keller-Weg 6 79539 Lörrach		
BAUHERR	Jeremy Tammik Hühnerbergweg 30 79539 Lörrach		
ARCHITEKT	KURIARCHITEKTEN Belchenstraße 80 79650 Schopfheim +49 7622 684 36 75 info@kuriarchitekten.de kuriarchitekten.de		KURI 2 AUSSEN TRIFFT INNEN
PLAN	Grundriss - Dachgeschoss		
DATUM	21.02.2024		LK
VERFASSER	Unterschrift Bauherr	Unterschrift Architekt	